

# Conference facilities



Albany Senior High School has an amazing facility for small to medium size conferences. We can cater for up to 250 participants in a modern educational environment.

From small meeting spaces, to larger rooms for conferences and exhibitions Albany Senior High School has spaces to suit all events. Every space on every level has floor to ceiling windows overlooking our native bush area or Albany Highway. A public announcement system is available to call attendees together, the school is 21st century wifi capable, and has onsite, undercover parking.

With easy access from both the northern motorway and the north western motorway Albany Senior High School is a perfect venue for your conference. We have a small team of students to assist with your sound and lighting requirements, and can provide IT support if needed.

**The focal point of our complex is the central atrium space.**

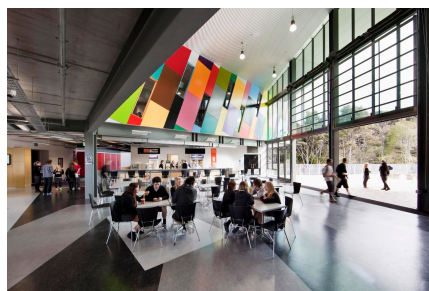

**This is a great space for break times and we have on site caterers who will provide terrific food at a good price.**

**On a nice day there is a plaza area for conference attendees to relax**



**Key note speakers can be accommodated in either the theatre or in a learning common space**

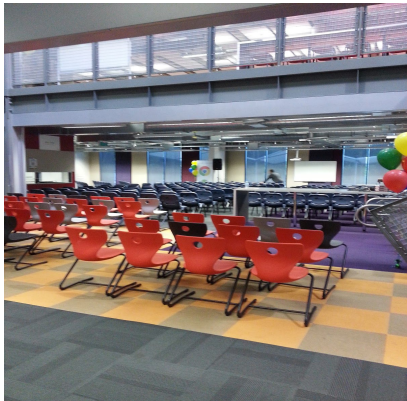

**A presentation space can comfortably accommodate 200 people and our theatre can accommodate 250 to 300 depending on the configuration**



## **Workshops and presentations**

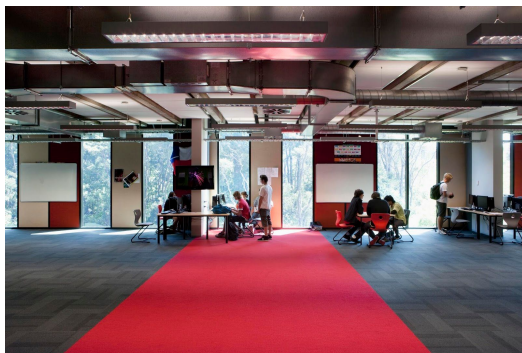

**Each Learning Common space can hold 3 concurrent “classes”.**

**The acoustics have been designed for concurrent teaching and work incredibly well.**

**Each space has a projector and whiteboard ready to go. Sets of speakers can be provided if needed.**

**Furniture can be either a number of square tables that seat 4 or the room can be set up presentation style**

**Or we have a range of round, high or low tables depending on what you would like.**

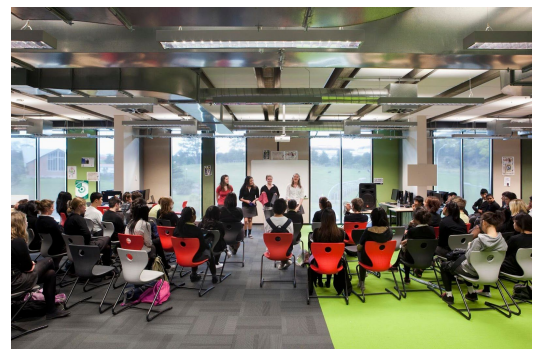

**If your presenter requires sound or would like to use a video we have smaller presentation rooms at the end of each Learning Common.**

**Natural internal flow and display spaces for sponsors.**



**The building has well designed internal walkways where attendees and sponsors can mix and mingle.**

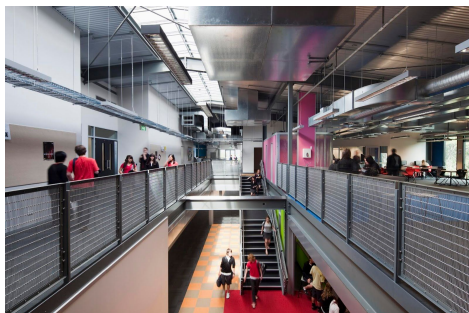

**Contact us :**

**If you would like more information, or would like to arrange a visit please email [businessmanager@ashs.school.nz](mailto:businessmanager@ashs.school.nz)**

**or telephone 09-4519065 and ask for the school's Business Manager.**